

# ASSEMBLY AND INSTALLATION INSTRUCTIONS

PD57111 / PD57112 / PD57115

**WARNING: BE SURE TO SHUT OFF POWER AT THE MAIN FUSE OR CIRCUIT BREAKER BOX BEFORE INSTALLING OR SERVICING THIS FIXTURE.**

**NOTE: 1. Before installing, consult local electrical codes for wiring and grounding requirements.  
2. READ AND SAVE THESE INSTRUCTIONS.**

1. Take out the socket with cord, thread the cord through cap nut, canopy and two holes of the strain relief.
2. Measure the desired length of the cord (A) from the canopy to the top side of the cover and leave an additional 9" of cord (B) above the canopy (include the canopy). Then cut off the unnecessary cord. (See Fig.1)
3. Adjust strain relief at 9" position from the top of the cord.
4. Mark the 3" of cord (C) from the top of the cord (B). Use a knife to peel off the insulation of the cord (C) carefully to expose the 3 wires on the inside. (See Fig.1)

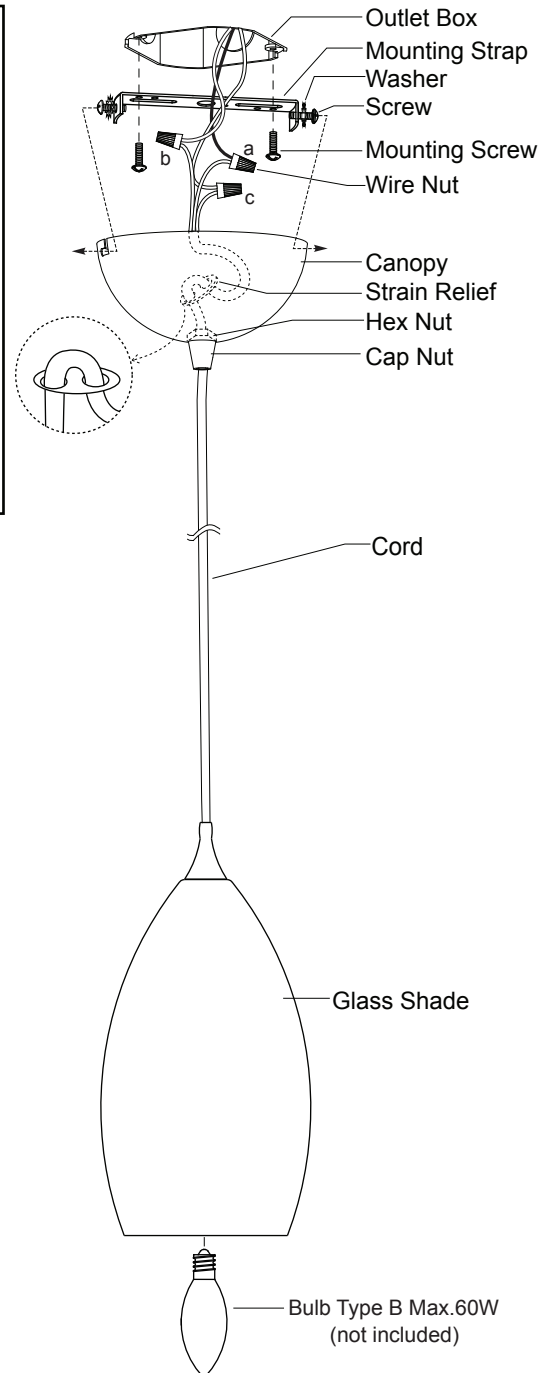
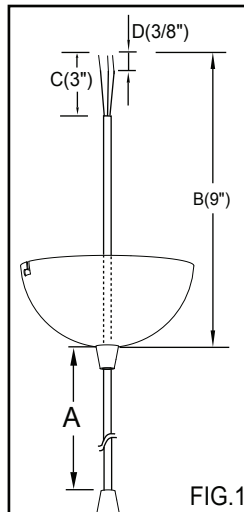

**Caution: Cutting too deep may cut off the three inside wires and destroy the insulation surface of the three inside wires.**

5. Peel off the 3 wires from the top about 3/8" long(D) to expose the copper for wiring.
6. Attach the mounting strap to the outlet box by using two mounting screws.
7. Pull out the outlet wires and the house grounding wire from the outlet box. Make wire connections using the wire nuts:
  - a. The clear wire marked "L" from the fixture to the black wire from the power source.
  - b. The clear wire with white line and marked "N" from the fixture to the white wire from the power source.
  - c. The clear grounding wire with green line and marked "⊕" from the fixture to the green grounding wire from power source.

Carefully put wires back into the outlet box.

8. Pull the cord ( A ) down slightly until the strain relief touches the hex nut.

**Note: Adjusting the strain relief of the canopy can decrease or increase the length of cord that is exposed.**

9. Attach the canopy to the mounting strap. Lift the canopy, allowing the two screws and washers to slide into the mating slots. Rotate the canopy clockwise until both screws from the mounting strap drop into the slot recesses. Tighten screws securely.
10. Install a bulb (not included). See relamping label at socket area or packaging for maximum allowed wattage.
11. Turn on the power at the main fuse or circuit breaker box.